

## KNIVES DIAMOND KNIVES



PARACENTESIS · SIDEPORT · UNIVERSAL .....	59
TRIFACET · CLEAR CORNEA .....	60
CRESCENT · STEP TRIFACET · LRI .....	61
MICROMETER · VISCOCANALOSTOMY · RETINAL SURGERY .....	62
KERATOME · CHALAZION · SCLERAL .....	63
CORNEAL SCARIFIER · DMEK SCRAPER .....	64
SATO .....	65
CRVO .....	66





**G-38475 DIACLEAN DIAMOND KNIFE**

for paracentesis  
1 mm wide spear  
titanium handle  
width 1.0 mm  
length 4.0 mm  
thickness 0.2 mm

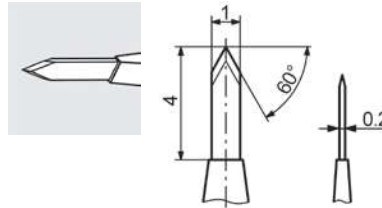

**G-38344 DIACLEAN DIAMOND KNIFE**

1 mm wide, 45° diamond blade  
titanium handle  
width 1.0 mm  
length 3.0 mm  
thickness 0.2 mm

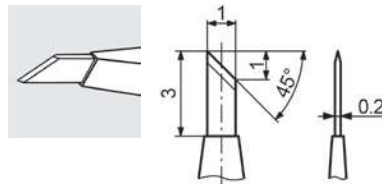

**G-38341 DIACLEAN DIAMOND KNIFE**

60° spear diamond blade  
titanium handle  
width 1.4 mm  
length 3.0 mm  
thickness 0.2 mm

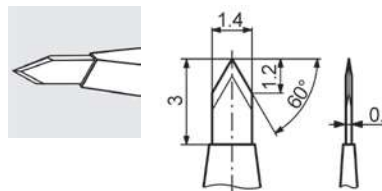

**G-38343 DIACLEAN DIAMOND KNIFE**

45° spear diamond blade  
titanium handle  
width 1.4 mm  
length 3.0 mm  
thickness 0.2 mm

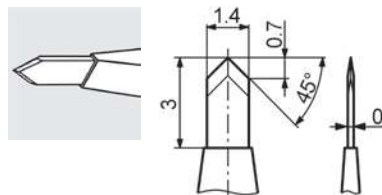

06

DIAMOND KNIVES: PARACENTESIS · SIDEPORT · UNIVERSAL



**G-38342**     **DIACLEAN TRI-FACET DIAMOND KNIFE**  
 1 mm wide tri-facet diamond blade  
 titanium handle  
 width 1.0 mm  
 length 3.0 mm  
 thickness 0.2 mm

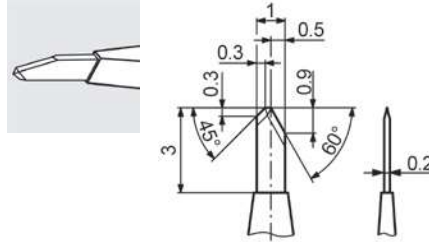

06

DIAMOND KNIVES: TRI-FACET · CLEAR CORNEA · TRAPEZOID · PHACO



**G-38473**     *PHAM*  
**DIACLEAN TRI-FACET DIAMOND KNIFE**  
 titanium handle  
 width 1.5 mm  
 length 3.0 mm  
 thickness 0.2 mm

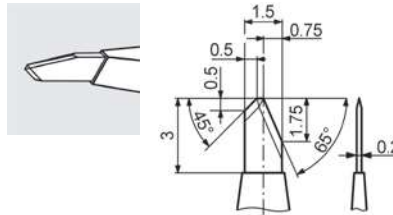

**G-38448**     **DIACLEAN CLEAR-CORNEA-INCISION DIAMOND KNIFE, 1.5/2.0 mm**  
 MICS trapezoid blade, 35° angled  
 4 cutting edges  
 titanium handle  
 width 1.5 / 2.0 mm  
 length 5.0 mm  
 thickness 0.2 mm

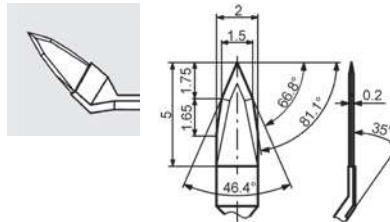

**G-38444**     **DIACLEAN CLEAR-CORNEA-INCISION DIAMOND KNIFE, 2.2 MM**  
 4 cutting edges, 35° angled  
 titanium handle  
 width 2.2 mm  
 length 5.0 mm  
 thickness 0.2 mm

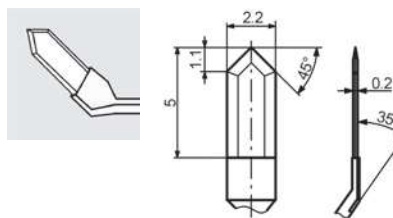



**G-38453**     **DIACLEAN CLEAR-CORNEA-INCISION  
DIAMOND KNIFE, 2.85 MM**  
4 cutting edges, 35° angled  
titanium handle  
width 2.85 mm  
length 5.0 mm  
thickness 0.2 mm

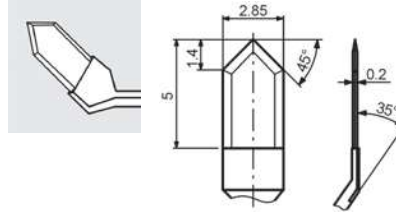

**G-38466**     **DIACLEAN DIAMOND  
CRESCENT KNIFE, 2.0 MM**  
round spatula shape, 40° angled  
titanium handle  
width 2.0 mm  
length 4.0 mm  
thickness 0.2 mm

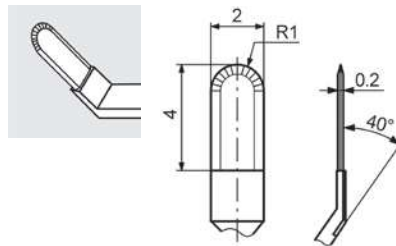

**G-31470**     **TRI-FACET DIAMOND STEP KNIFE**  
single footplate, titanium handle  
stepwise adjustable  
in sterilizing case  
width 1.0 mm  
length 3.0 mm  
thickness 0.2 mm

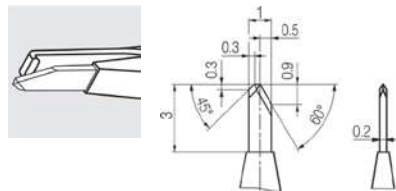

**G-31468**     **LIMBAL RELAXING INCISION  
DIAMOND KNIFE**  
LRI knife with 0.6 mm precalibrated depth  
single footplate, titanium handle  
width 1.0 mm  
length 3.0 mm  
thickness 0.2 mm

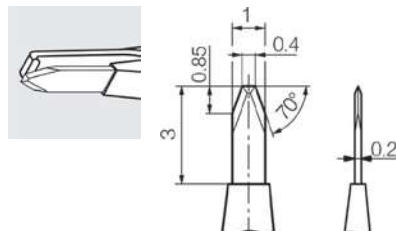

**06**

DIAMOND KNIVES: CLEAR CORNEA · CRESCENT · STEP KNIFE · LRI



**G-31480**

**DIAMOND MICROMETER KNIFE**

tri-facet for keratotomy  
vertical and 15° cutting edges with  
0.2 mm flat base cutting edge  
double footplate, titanium handle  
width 0.6 mm  
length 3.0 mm  
thickness 0.1 mm

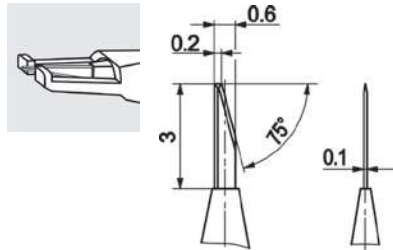

**G-19345**

**DIAMOND MICROMETER KNIFE**

for keratotomy  
single 45° cutting edge  
double footplate, titanium handle  
width 1.0 mm  
length 3.0 mm  
thickness 0.2 mm

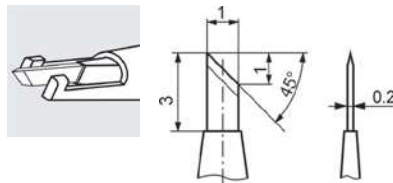

**G-31487**

**DIAMOND KNIFE**

for viscocanalostomy  
0.5 mm wide, 70° diamond blade  
width 0.5 mm  
length 4.0 mm  
thickness 0.2 mm

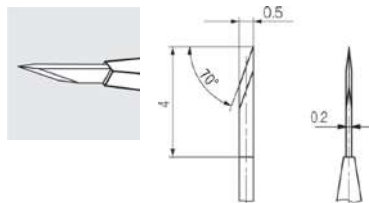

**G-31477**

**RETINA DIAMOND KNIFE**

45° cutting edge  
20 gauge / 0.9 mm  
titanium handle  
width 0.9 mm  
length 3.0 mm  
thickness 0.2 mm

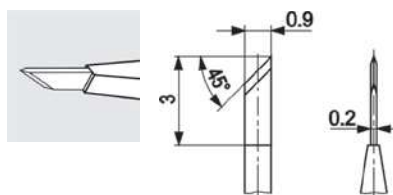



**G-14420** *HAMBURG MODEL*  
**KERATOME**  
angled at 14 mm from tip  
10 mm cutting surface  
1,1 mm wide  
overall length 120 mm



**G-14000** **CHALAZION KNIFE**  
straight, delicate  
10 mm cutting surface  
1.8 mm wide  
overall length 120 mm



**G-14105** **MICRO ROUND KNIFE**  
for viscocanalostomy  
0.8 mm diameter disc-shaped blade  
overall length 112 mm

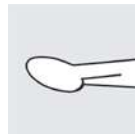

**G-14180** *BONN MODEL*  
**SCLERAL KNIFE**  
7 mm blade, rounded tip  
overall length 126 mm



**G-14185** *BONN MODEL*  
**SCLERAL KNIFE**  
4 mm blade, rounded tip  
overall length 126 mm

06

KERATOME · CHALAZION · VISCOCANALOSTOMY · SCLERAL



*KUHNT*  
**CORNEAL SCARIFIER**

rounded tip  
overall length 123 mm  
fig. 1, 5.5 mm x 2.5 mm blade  
fig. 2, 4.5 mm x 2.0 mm blade

**G-14010**  
**G-14020**

06

CORNEAL SCARIFIER · DMEK SCRAPER



*SZURMAN*  
**DMEK PREPARATION SCRAPER**  
4.0 mm lower blade, blunt  
1.5 mm rounded tip, sharp  
for removal of Descemet's membrane from graft  
overall length 117 mm

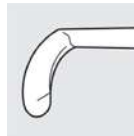

**G-38621**



*PAUFIQUE*  
**KERATOPLASTY KNIFE**  
2 mm long cutting edge  
1.7 mm wide semi-circular tip  
overall length 105 mm

**G-14200**



*LOHMANN*  
**LASEK EPI PEELER**  
"Hockey" knife with  
5 mm bottom blade and 2 mm front blade  
overall length 123 mm

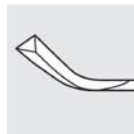

**G-33670**

**STILETTO**  
45° lancet  
overall length 53 mm  
for instruments with

**G-33022**  
**G-33025**  
**G-33026**

23 gauge / 0.6 mm  
20 gauge / 0.9 mm  
19 gauge / 1.1 mm







**G-14165**     **SATO KNIFE**  
1.5 mm cutting edge  
pointed tip  
overall length 123 mm

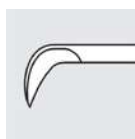

**G-16200**     *DARDENNE*  
**SATO KNIFE**  
1.2 mm cutting edge  
pointed tip  
overall length 123 mm



**G-37555**     *FOERSTER*  
**SATO KNIFE**  
conical shaft  
front: 30 gauge / 0.3 mm  
rear: 20 gauge / 0.9 mm  
overall length 125 mm



**G-14162**     *HANSEN*  
**SATO KNIFE**  
double edge,  
for arteriovenous dissection  
20 gauge / 0.9 mm  
overall length 130 mm



G-12200

**CRVO KNIFE**

for Radial Opticus Neurotomy (RON)  
with Central Retinal Vein Occlusion (CRVO),  
20 gauge / 0.9 mm  
overall length 120 mm

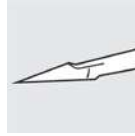

G-12220

*DITHMAR*  
**CRVO KNIFE**

with preset incision depths at 1.5 mm,  
for radial opticus neurotomy (RON)  
with Central Retinal Vein Occlusion (CRVO),  
20 gauge / 0.9 mm  
overall length 129 mm

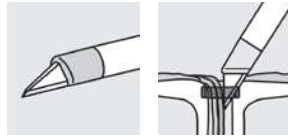

06

CRVO